



Catalog 2023

Lifting & Handling | Measure & Control
Height Safety

Export



www.tractel.com

Tractel® is a world leading safety specialist providing reliable, innovative and cost-effective working-at-height solutions and services. These solutions are used in many end-user applications, in particular in industrial, construction, energy, telecoms and infrastructure projects..

Tractel® solutions portfolio comprises of:

- **Height Safety** - Leading provider of working-at-height personal protective equipment – fall arrest devices (Stopfor™, Blocfor™, Derope™), anchors, harnesses - as well as collective protective equipment, such as guardrails, (Bluewater™), safety gates (Fabenco™) and safety nets (Knot®).
- **Load Measurement & Control** - European leader in industrial load measurement and control – Dynafor™, Handifor™, Dynasafe™, Dynaline, Dynarope, and Dynaplug.
- **Lifting & Handling** - World leader in pass-through manual wire rope hoists (Tirfor®) and pass-through electrical wire rope hoists (Tirak™, Minifor™), clamps, pulleys and hooks, as well as ground handling equipment.
- **Temporary & Permanent Access** - World leader in hoists (Tirak®) and aluminium platforms (Alta, Skysafe™), mast climbing work and transport platforms and construction elevators (Scandclimber®), Building maintenance units and permanent access solutions for industry, infrastructure and buildings.
- **Services** - In-situ inspection and maintenance services for permanent access equipment, workshop maintenance and general overhauls of mechanical equipment, as well as training and rental services.



Established more than 80 years ago, **Tractel®** today has significant manufacturing facilities in Europe (France, Germany, Poland, Spain), the USA (Minneapolis, Houston), Canada (Toronto, Montreal), China (Shanghai), Singapore and Turkey. These facilities are supported by dedicated centres of excellence in R&D, engineering and safety standards.

Tractel® has customers in 120 countries, subsidiaries in 19 countries, 10 000 distributors around the world, and employs around 1 100 peoples.

This network of expertise, experience and geographical locations allows **Tractel®** to achieve global reach with local presence..



ESG – Environmental, Social and Governance Policy

The Tractel Group has set-up an ambitious Environment, Social and Governance (ESG) policy. Our ESG policy commits us collectively to do more for people, society and the environment. We are convinced that those who share our ambition, be they customers, suppliers, shareholders or employees, will join us in this positive dynamic.

Our ESG policy was designed taking into account, among others, the European Non-Financial Reporting Directive, the upcoming Corporate Sustainability Reporting Directive (CSRD) and the UN Sustainable Development Goals.

Our ESG policy covers 11 focus areas that are grouped in 4 main pillars.



We set our priorities based on the dual materiality analysis shown below.

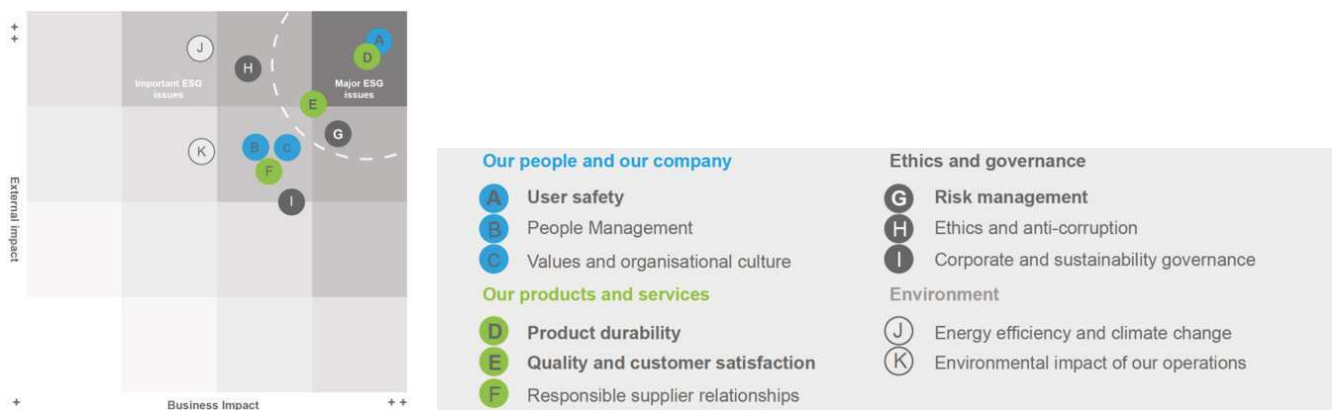

All 11 areas are covered by a detailed action plan, shared with, and owned by, company managers.

Our results are measured by 32 KPIs, ranging from CO2 emissions to work accidents and complaints-handling times. Each has a target by 2025.

SALES ORGANISATION

All our products are meant for professional use only.

Minimum value per order € 100 Net. Our supplies are manufactured according to the terms shown on our order acknowledgment, a copy of which is available on request. We reserve the right to modify, without prior notice, the characteristics, the equipment, the prices and Sales Conditions of our products. Our delivery time will be indicated on our order acknowledgment.

EXPORT DEPARTMENT

(sales and marketing)

Sales Export director

Phone: +352 43 42 42 654

Email: nikolaas.mertens@tractel.com

Export Sales back office

Phone: +352 43 42 42 652

Emails: elodie.alexandre@tractel.com - leon.daenen@tractel.com

Sales Europe

Phone: + 352 43 42 42 653

E mail: michael.derler@tractel.com

Sales Middle East & Central Asia

Phone: + 352 43 42 42 654

E mail: julie.melchior@tractel.com

Sales Africa

Phone: + 352 43 42 42 654

E mail: julie.melchior@tractel.com

Sales Asia & Pacific

Phone: + 65 881 05 735

E mail: romain.ricard@tractel.com

Sales South America

Phone: + 352 43 42 42 654

E mail: nikolaas.mertens@tractel.com

SALES ADMINISTRATION

(invoicing, logistics and delivery)

Sylvie Brie (Head of department)

+333 25 210 716

Dolorès Parisotto (Middle East, Africa)

+333 25 210 715

Florence Merat (Europe, South of America, Asia)

+333 25 210 714

Doriane Ly

+333 25 210 814

Product ranges

Height Safety Products & Systems



Load Measurement and Control



Lifting and Handling

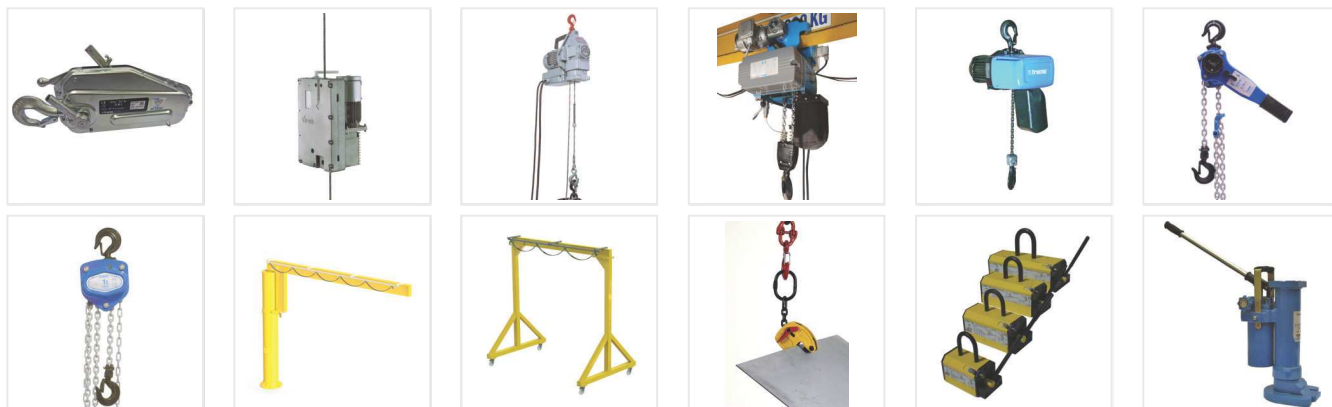

Temporary & Permanent Access



Traceability platform

Instant access to key product information

Introducing **Tractel**®'s new product information and traceability platform – an exciting new tool giving you instant access to a range of technical information related to your product.

Simply use a QR code reader to scan the identification label on the product or packaging to gain access to the information you need; direct to your phone, tablet or computer.



Packaging product label
(on packaging)



Product label
(on product)



EAN Code label
(on packaging)

Instant access to:

- **Product Identification information** (batch & serial number, manufacturing date etc).
- **Product Data** (available to download to your device):
 - Certificate of Conformity (Notified body product certificate)
 - User manual
 - Technical data sheet
 - Declaration of conformity
- **Traceability system**
 - TRACTEL® service information : summary of service performed by TRACTEL®
 - Possibility to register & trace the key life events of the equipment: date of the first use, attribution of the equipment to a user, periodic inspection, maintenance operation, disposal, etc...

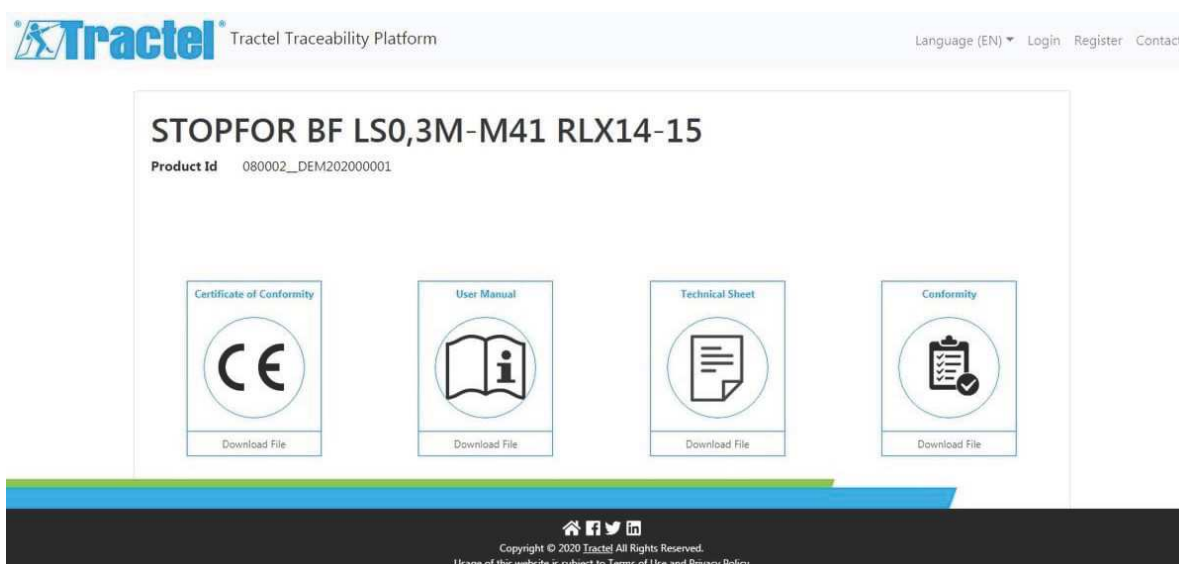

Traceability platform

How to use it ?

- 1 Download a free QR code scanner on your smartphone, tablet or computer.



Example :
QR Code Reader for Android

- 2 Open the QR Code Scanner app and scan the code on the packaging or product.



You will be redirected to a special Tractel® website with a webpage dedicated to your product.

- 3 Find all the relevant information of the product you scanned.

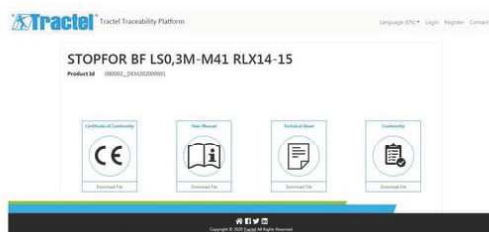

Available downloads in PDF format:

- Identification information of the product: batch & serial number, manufacturing date.
- Certificate of Conformity (Notified body product certificate)
- User manual
- Technical data sheet
- Declaration of conformity

- 4 Register to have immediate access to advanced functionalities.



- Details to create an account:
 - Name
 - E-mail address
- Create a password to secure your account.

- 5 Enter and track the key life information of your product.

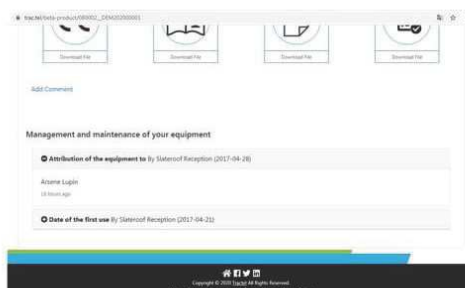

- Date of the first use
- Attribution of the equipment to a user
- Periodic inspection
- Maintenance Operation
- Disposal

Summary

1 - GENERAL INFORMATION

2: Contacts

3: Product ranges

4: Traceability platform



7 - LIFTING AND HANDLING

10: Wire rope hoists

80: Chain hoists

105: Clamps

134: Lifting beams

150: Fall arresters

153: Floor handling equipment



155 - MEASUREMENT & CONTROL

156: Dynafor

167: Dynasafe

171: Displays

172: DMU

173: Dynarope

175: Anchor tester plate

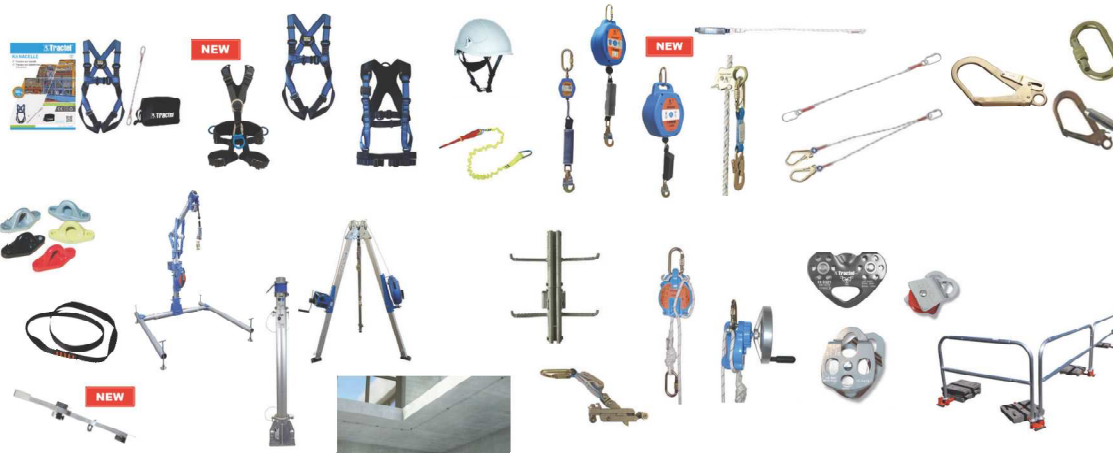

176 - HEIGHT SAFETY PRODUCTS

182: PPE kits

190: Harnesses

210: Accessories

218: Fall arresters

243: Lanyards

251: Connectors

257: Anchors

272: Confined space

292: Lifelines

311: FABA

319: Rescue

323: Rope access

330: Guardrail

1. Lifting and handling



General safety recommendations

For lifting and load handling

For every use of lifting gear, it is mandatory to respect the safety instructions.

The rules outlined below refer to the right safety approach but don't replace the user manual's instructions of each lifting product.

The lifting operations must be carried out by trained operators.

Tractel® lifting gear provide optimum safety if handled properly.

What to do

- Verify the working load limit of your lifting gear, lifting accessories, different anchoring solutions and supporting structure.
- Verify that the lifting gear is in perfect condition and foreseen of a readable product label.
- Check the load lifting chain on possible damage
- Ensure the right load suspension and its accessories
- Carry out the periodical product inspections.
- Respect recommendations for stocking properly your gear.

What you should not do

- Starting the lifting operation while the load is not fixed properly or when persons are located in the working area.
- Balancing the load during lifting operations.
- Lifting/lowering the load without verification of the lifting speed.
- Have the load suspended during long extended periods.
- Move under loads.
- Drop lifting gear : hoists and winches should always be placed correctly on the floor.
- Modify one or more components of your lifting gear.



Advise - Audits - Assistance

Manage the safety and reliability of your lifting gear as well its compliance with legal requirements.

Legal and regulatory framework :

Because the best way to limit the risk is to anticipate it ...

Load lifting equipment can generate serious risks for everybody's safety.

Tractel® service approach

Tractel® accompagnies you with the safety management of your working environment.

Periodical inspections are aimed to maintain your lifting gear in good condition and are not intended to verify the compliance with the design rules. Therefore, the periodic inspection reports are not the reflection of the evaluation of the conformity with the regulation.

Approach Tractel® :

- Presentation of services by Tractel®
- Inventory review of the lifting gear
- Visit of the technical workshop
- Audit of the lifting gear and its working environment
- Verification and analysis of the safety logbook and the last audits of third party inspection agencies
- Proposal of actions to be carried out

In order to enable Tractel® to proceed at best to this audit, the auditee shall provide the following elements:

- List of the lifting gear
- Competent staff for the operation of the lifting gear
- The following documents: logbook, service records, user manuals, last audit reports from third party inspection agencies

Chain Hoists



Stainless steel manual chain hoists

Tralift Cleantech

Tralift Cleantech is a range of stainless steel manual chain hoists.

The Tralift Cleantech series offers a solution for lifting and handling in more specialised areas such as food processing, chemical industries, clean rooms, highly corrosive environments such as water treatment and chlorine atmospheres as well as industries where steam is used.

All components in contact with the environment are manufactured using stainless steel Grade 304.

The encased gears and brake are made of carbon steel.

Load and hand chains are also made of stainless steel Grade 304 and importantly so are the top and bottom hooks and safety catches.

The chain hoist can be coupled with the Corso Cleantech push trolley to have a complete set in stainless steel Grade 304.



NEW

WLL	Lifting Height (m)	Number of Falls	Load Chain (mm)	Hand Chain (mm)	Code/Price standard lifting height 3m	Code/Price lifting height 1m	Stainless steel load chain per m	Stainless steel hand chain per m
0.5 t	3	1	6x18	5x23.3	294899	294929	288027	288167
1 t	3	1	7x21	5x23.3	294909	294939	288037	288167
2 t	3	2	7x21	5x23.3	294919	294949	288047	288167

Tralift Cleantech dimensions and key components

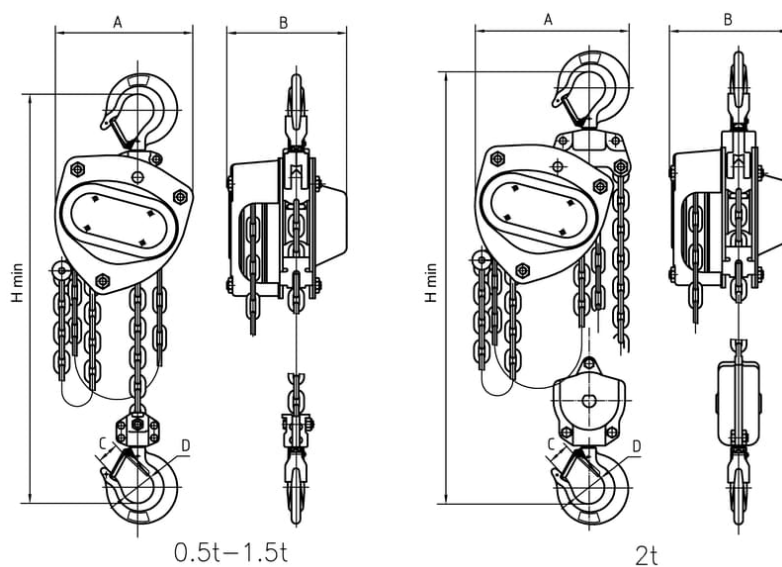

WLL	Number of Falls	A	B	C	D	Hook Distance (mm)	effort on the hand chain	Load Chain (mm)	Hand Chain (mm)	Weight (kg)
0.5 t	1	172	151	26	40	376	15	6x18	5x23.3	13
1 t	1	172	151	26	40	376	31	7x21	5x23.3	14
2 t	2	192	151	34	50	425	34	7x21	5x23.3	21

Accessories for Tralift Cleantech

Corso Cleantech stainless steel trolley



The Corso Cleantech trolley is:

- used as a mobile anchor point on a "H" or "I" beam for lifting devices particularly Tralift Cleantech and are moved by pushing the load,
- a robust device, made with Grade 304 stainless steel,
- specially designed for applications in the food, pharmaceutical, cosmetics and clean room sectors, as well as aggressive environments with salt water or dust due to their excellent resistance to corrosion.

TECHNICAL CHARACTERISTICS

- compact and light device,
- device mainly made up of stainless steel components,
- stainless steel wheels mounted on ball bearings greased for life,
- stainless steel side plates with end bumpers and fall arrest device,
- hanger bar with adjustment spacers, locking nuts and safety pins,
- designed and built to withstand dynamic tests at 1.1 x WLL and static at 1.5 x WLL and to guarantee a minimum mechanical resistance of 4 x WLL

STANDARDS

The devices Corso Cleantech conforms to:

- to the Machine Directive 2006/42 / EC and this machinery fulfils all the relevant provisions of the Supply of Machinery (Safety) Regulations 2008 (SI 2008/1597) as amended (SI 2011/1042, SI 2011/2157, SI 2019/696).
- to the European standard EN13157+A1:2009



Model	A	B	C	D	E	F	G	H	I	J	K	Mln.Radius (mm)	Weight (kg)	Product Code
Corso Cleantech 0,5t	187	32	25	100	199	245	50-152	1.5-3	29.5	104	8	1000	5,8	294869
Corso Cleantech 1t	229	40	30	120	246	327	64-203	1.5-3	27	127	10	1000	12	294879
Corso Cleantech 2t	268	52	38	132	276	345	88-203	1.5-3	27	150	12	1100	19,5	294889

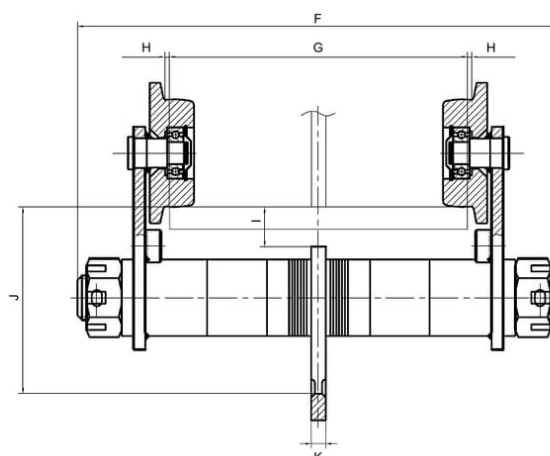
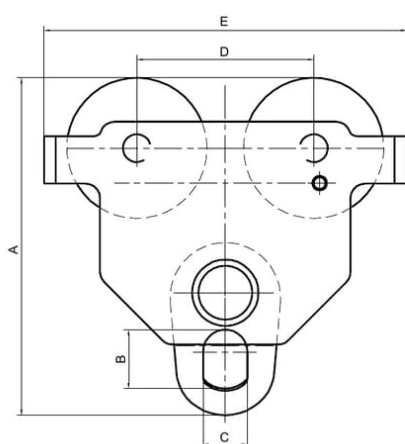

Tralift - Manual chain hoists

The Tralift manual hand chain hoist has a unique Tractel design which is compact, light yet robust, able to tackle the most extreme lifting conditions.

Ideal for rental fleets, industrial and construction application. Tractel also offer Tralift in black format for the

entertainment industry.

Certified by TÜV Rheinland to EN13157 for capacities 500kg and above when fitted with Corolim Grade 8 EN818-7

load chain which also offers excellent corrosion protection.



- Corrosion resistant Corolim® load chain with less wear and longer life – EN818-7 compliant
- EN13157 fully compliant TÜV Rheinland certified
- Compact and lightweight
- Robust design with cast steel safety catches
- Easily portable for use anywhere
- Swivel hook with overload indication and robust cast steel safety catches
- Option: Overload protection for safe and secure operation reducing unnecessary damage to the hoist – 0.5t to 20t

Tralift dimensions and key components

1. Load chain
2. Lifting hook
3. Pulley block
4. Low limit stop
5. Suspension hook
6. Safety catch
7. Hand chain

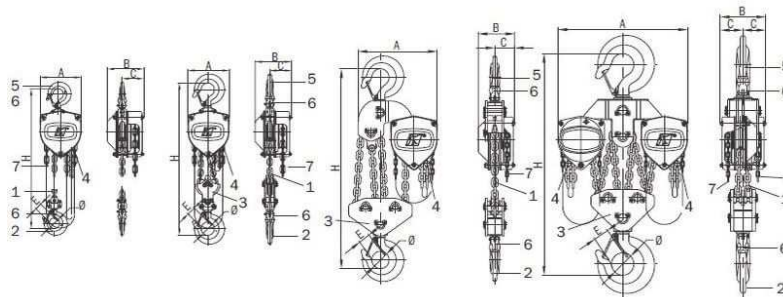

0.5t/1t/1.5t/2t WLL
WLL2t/3t/5t WLL 10t WLL 20t

WLL	A	B	C	D	Ø	Hook Distance (mm)	Weight (kg)
0.25	100	110	58	20	28	230	3,7
0.5	132	117.5	70.5	22	35	330	9
1	156	139	83.5	27	40	380	12.4
1.5	178	154	87	29	45	430	16.5
2	196	156.5	89.5	33	50	470	19.6
2	156	139	83.5	33	50	520	17.2
3	178	154	87	39	55	600	24.2
5	229	180	99	44	68	700	42
10	391	180	99	58	85	920	85.1
20	641	224	112	77	110	1060	165.1

En mm.

Tralift without load limiter



Model	3 m		4 m		5 m		6 m	
	ref.	Code	ref.	Code	ref.	Code	ref.	Code
0,25*	1 fall	75769					1 fall	75779
0,5	1 fall	222239	1 fall	222329	1 fall	222419	1 fall	222509
1	1 fall	222249	1 fall	222339	1 fall	222429	1 fall	222519
1,5	1 fall	222259	1 fall	222349	1 fall	222439	1 fall	222529
2	2 falls	222269	2 falls	222359	2 falls	222449	2 falls	222539
2	1 fall	222279	1 fall	222369	1 fall	222459	1 fall	222549
3	2 falls	222289	2 falls	222379	2 falls	222469	2 falls	222559
5	2 falls	222299	2 falls	222389	2 falls	222479	2 falls	222569
10	4 falls	222309	4 falls	222399	4 falls	222489	4 falls	222579
20	8 falls	222319	8 falls	222409	8 falls	222499	8 falls	222589

* not EN13157

For chain lengths different from the table above:

WLL (t)	Number of Falls	Basic kit: 1 m of chain (lifting and maneuvering)	Additional lifting height	Additional manipulation chain
0,5	1	279229	238227	238347
1	1	279239	238237	238347
1,5	1	279249	239857	238347
2	2	279259	238257	238347
2	1	279269	238247	238347
3	2	279279	238267	238347
5	2	279289	238277	238347
10	4	279299	238287	238347
20	8	279309	238297	238357

Example:

Costing for 10 m of lifting chain and 8 m of operating chain, WLL 3 t.

279229 + (9 x 238267)

Tralift with load limiter



Model	3 m		4 m		5 m		6 m	
	ref.	Code	ref.	Code	ref.	Code	ref.	Code
0,5	1 fall	222599	1 fall	222689	1 fall	222779	1 fall	222869
1	1 fall	222609	1 fall	222699	1 fall	222789	1 fall	222879
1,5	1 fall	222619	1 fall	222709	1 fall	222799	1 fall	222889
2	2 falls	222629	2 falls	222719	2 falls	222809	2 falls	222899
2	1 fall	222639	1 fall	222729	1 fall	222819	1 fall	222909
3	2 falls	222649	2 falls	222739	2 falls	222829	2 falls	222919
5	2 falls	222659	2 falls	222749	2 falls	222839	2 falls	222929
10	4 falls	222669	4 falls	222759	4 falls	222849	4 falls	222939
20	8 falls	222679	8 falls	222769	8 falls	222859	8 falls	245009

WLL (t)	Number of Falls	Basic kit: 1 m of chain (lifting and maneuvering)	Additional lifting height	Additional manipulation chain
0.5	1	279319	238227	238347
1	1	279329	238237	238347
1.5	1	279339	239857	238347
2	2	279349	238257	238347
2	1	279359	238247	238347
3	2	279369	238267	238347
5	2	279379	238277	238347
10	4	279389	238287	238347
20	8	279399	238297	238357

Example:

Costing for 10 m of lifting chain and 8 m of operating chain, SWL 3 t.
 $279369 + (9 \times 238267) + (7 \times 238347)$

Options

Chain bags

WLL (kg)	Nb of falls	Chain length (m)									
		2	5	6	12	18	20	22	30	35	
500	1		62902			62912					
1000	1		62902			62912					
1500	1		62922	62932				62942			
2000	2		62902	62912							
2000	1		62922	62932				62942			
3000	2		62932			62942					
5000	2		62952	62962							



Bravo lever hoist aluminium version

Bravo AC aluminium lever hoists



The Bravo AC series lever hoist with aluminium casings is lightweight and easily carried in its own bag, complete with belt loop.

- Aluminium casings
- Compact and lightweight
- Robust design equals less down time
- Easily portable for use anywhere
- Swivel hook
- Pull-through feature to quickly adjust the load chain
- Carry bag with belt loop
- Option: chain locking and shortening device for greater safety ensuring the load or tension is never lost

Model	WLL	Lifting Height (m)	Pressure (N)	Load Chain (mm)	Weight (kg)	Product Code
Bravo AC 250 kg	0.25	1,5	170	4 x 12	2.3	251129
Bravo AC 250 kg	0.25	3	170	4 x 12	2.8	251139
Bravo AC 500 kg	0.5	1,5	190	5 x 15	3.3	251149
Bravo AC 500 kg	0.5	3	190	5 x 15	4.1	251159

Bravo AC lever hoists dimension & key components

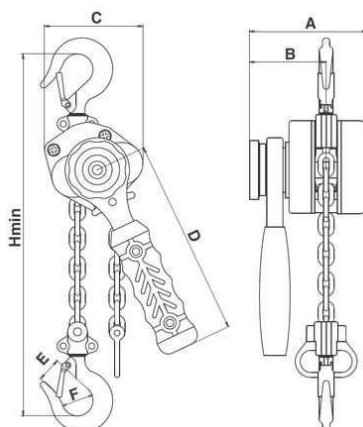

WLL	A	B	C	D	E	Ø	Hook Distance (mm)	Max effort of the handle (daN)
0.25	100	61	80	160	23	32	230	17
0.5	110	68	100	160	25	34	270	19

All dimensions in mm.

Bravo without load limiter

Machine Directive 2006/42/CE EN13157 - A1:2009 conformity



bravo™ lever hoists from Tractel® are particularly suitable for tensioning, lifting, handling and traction operations, with optimum safety thanks to exclusive desynchronised pawls preventing any unintentional release of the load.

- Permanent load control
- Automatic load brake closure
- Optimised safety against unintentional release of the load thanks to the two independent desynchronised pawls
- Free wheel system / neutral position: fast and easy pull through of the load chain
- Wide range: capacities from 250 kg to 9 t
- Roller and block chain guides ensuring a smooth chain action through the hoist
- Galvanised fittings, epoxy paint for much greater resistance to aggressive environments
- Forged steel hooks with 360° rotation and overload opening indicators
- Compact with a light weight simplifies use and transport
- Rubber handle improves grip



WLL (t)	1,5 m		3 m		4,5 m		6 m	
	Nb of falls	Code	Nb of falls	Code	Nb of falls	Code	Nb of falls	Code
0,25	1	75749					1	75759
0,5	1	199379	1	199389	1	199399	1	199419
0,75	1	199009	1	199069	1	199129	1	199189
1	1	199029	1	199089	1	199149	1	199209
1,5	1	199039	1	199099	1	199159	1	199219
3	2	199049	2	199109	2	199169	2	199229
6	3	261189	3	261199	3	261209	3	261219

For chain lengths different from the table above:

WLL (t)	Nb of falls	Code	Additional lifting height (m of chain)	Option Chain Locking Device CLD integrated on the chain hoist*
0,5	1	279099	238177	196898
0,75	1	279109	238187	196908
1,5	1	279129	238187	196908
3	2	279139	238197	196918
6	2	279149	238207	196928
9	2	279159	238217	196928

Example (non-standard lift height) : *Exemple (CLD mounted on hoist) :
 10m of chain, WLL 3 t. 3 m of chain, WLL 3 t, option CLD mounted.
 279139 + (9 x 238207) 279139 + (2 x 238207) + 196898

Bravo with load limiter



bravo™ lever hoists from Tractel® are particularly suitable for tensioning, lifting, handling and traction operations, with optimum safety thanks to exclusive desynchronised pawls preventing any unintentional release of the load.

- Permanent load control
- Automatic load brake closure
- Optimised safety against unintentional release of the load thanks to the two independent desynchronised pawls
- Free wheel system / neutral position: fast and easy pull through of the load chain
- Wide range: capacities from 750 kg to 9 t
- Roller and block chain guides ensuring a smooth chain action through the hoist
- Galvanised fittings, epoxy paint for much greater resistance to aggressive environments
- Forged steel hooks with 360° rotation and overload opening indicators
- Compact with a light weight simplifies use and transport
- Rubber handle improves grip
- Compliance with Machine Directive 2006/42/CE
- EN13157 + A1:2009 conformity



WLL (t)	1,5 m		3 m		4,5 m		6 m	
	Nb of falls	Code	Nb of falls	Code	Nb of falls	Code	Nb of falls	Code
0,75	1	200939	1	210009	1	210079	1	210149
1	1	200959	1	210029	1	210099	1	210169
1,5	1	200969	1	210039	1	210109	1	210179
3	2	200979	2	210049	2	210119	2	210189
6	3	261269	3	261279	3	261289	3	261299

For chain lengths different from the table above:

WLL (t)	Nb of falls	Code	Additional lifting height (m of chain)	Option Chain Locking Device CLD integrated on the chain hoist*
0.75	1	279169	238187	196908
1.5	2	279189	238187	196908
3	1	279199	238197	196918
6	2	279209	238207	196928
9	2	279219	238217	196928

Example (non-standard lift height): * Example (CLD mounted on hoist):
 10 m of chain, WLL 3 t 3 m of chain, CMU 3 t, option CLD mounted.
 $279199 + (9 \times 238207) 279139 + (2 \times 238207) / 196898$

Chain Locking Device - CLD

The CLD chain locking device acts as an adjustable limit on the Bravo & Tralift lever hoist when lowering the load.

The chain locking device can be used with Bravo lever hoists for load lifting, load pulling and rope tensioning applications.

The chain locking device is intended to be a retrofitted accessory to adapt all models and capacities of Bravo & Tralift hoists supplied by Tractel in compliance with the size of the chain. The CLD acts as a chain end stop, which can be adjusted to any position on the free side of the load chain.

Modèle	CMU du palan associé (kg)
250 kg and 500 kg	196438
750 kg and 1 ton	196448
1.5 ton	196458
3.6 ton and 9 ton	196468

Possibility of mounting the CLDs on the hoists in the factory.



Range of Electric Chain Hoists



volt trac™

- **WLL ranging from 125 to 2000 kg**
- Warranty 18 months
- Designed for frequent use
- Fit for challenging environments: IP 55
- Extra low noise level
- Galvanized load lifting chain



tralift™ TT

- **WLL ranging from 250 to 2000 kg**
- Warranty 3 years
- Designed for frequent use
- Fit for challenging environments : IP 65
- Low noise level: 65dB
- Stainless steel models available
- Special high performance load lifting chain
- Low headroom



Volt trac

Range of electric chain hoists - 250 to 2 000 kg

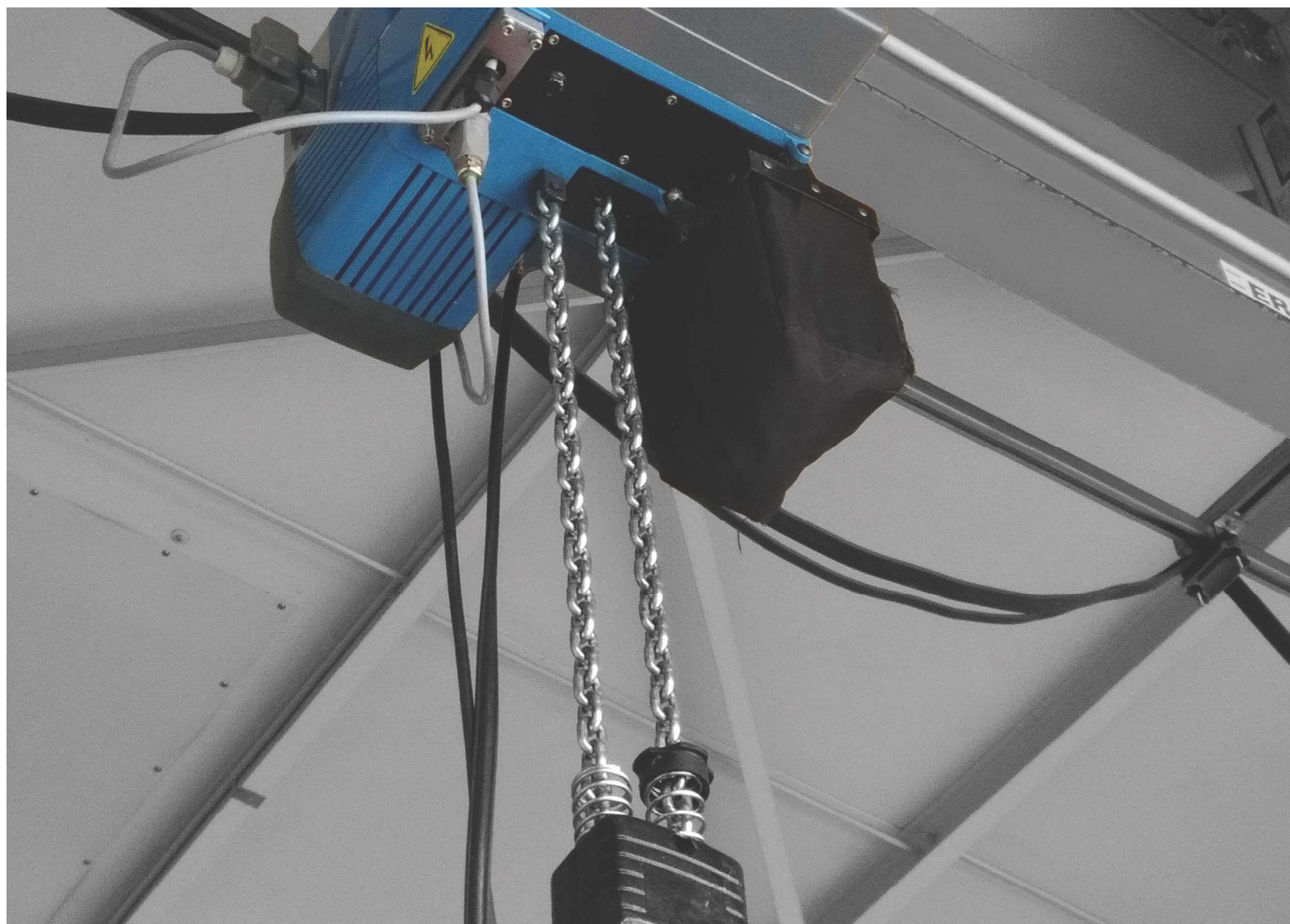

Volt trac

Range of electric chain hoists - 250 to 2 000 kg

Customize your Volt trac hoist starting from the starter kit.

Add the desired options to get the Volt trac hoist that matches your project.



Lifting height 3 m / Pendant control box 1,80 m					Options								
WLL (kg)	Nb of falls	Nb of speeds	Lifting speed (m/min)	Code	Additional lifting height		Pendant control box : additional meter		e-trolley 1 speed 10 m/min	e-trolley 2 speeds 19-6 m/min	e-trolley 2 speeds 9-3 m/min	Additional meter pendant control box Hoist + e trolley	
					Add m	Lg Max	Add m	Lg Max				Add meter	Lg Max
250	1	1	10	280209	270917	25 m	195127	25 m	276257	276317	276517	239597	25 m
500	2	1	5	280219	270927	25 m	195127	25 m	276267	276327	276527	239597	25 m
500	1	1	8	280229	270937	25 m	195127	25 m	276277	276337	276537	239597	25 m
500	1	2	8/2	280239	270937	25 m	195127	25 m	276417	276477	276577	239597	25 m
1,000	2	1	4	280249	270947	25 m	195127	25 m	276287	276347	276547	239597	25 m
1,000	2	2	4/1	280259	270947	25 m	195127	25 m	276427	276487	276587	239597	25 m
1,000	1	1	8	280269	270957	25 m	195127	25 m	276297	276457	276557	239597	25 m
1,000	1	2	8/2	280279	270957	25 m	195127	25 m	276437	276497	276597	239597	25 m
2,000	2	1	4	280289	270967	25 m	195127	25 m	276307	276467	276567	239597	25 m
2,000	2	2	4/1	280299	270967	25 m	195127	25 m	276447	276507	276607	239597	25 m

Model	Product Code
250 kg - 1000 kg, 68 - 320 mm	108937
2000 kg 76 - 320 mm	108947

Chain bags

WLL (kg)	Nb of falls	1	2	3	4	5	6	7	8	9	10	12	13	15	18	20	25	30	40
250	1															276617			
500	2									276617			276627			276637			
500	1															276647			
1000	2									276647			276657			276667			
1000	1											276677				276687			
2000	2					276677						276697				276707			

Volt trac

Options

Eye suspension for Volt trac

Model	Product Code
250 kg, 1fall	270987
500kg, 2 falls	270997
500 kg, 1 fall	274007
1000kg, 2falls	274017
1000 kg, 1 fall	274027
2000 kg, 2 falls	274037

Trolley limit switch

Model	Product Code
trolley limit switch	75257

Radio remote control

Model	Product Code
250 kg 1 fall	274047
500 kg 1 fall	274057
1000 kg 1 fall	274067
500 kg 2 falls	276717
1000 kg 2 falls	276727
250 kg 1 fall & trolley 1 fall	274087
500 kg 1 fall & trolley 1 fall	274097
1000 kg 1 fall & trolley 1 fall	274107
500 kg 2 falls & trolley 1 fall	276737
1000 kg 2 falls & trolley 1 fall	276747
250 kg 1 fall & trolley 2 falls	276757
500 kg 1 fall & trolley 2 falls	276767
1000 kg 1 fall & trolley 2 falls	276777
500 kg 2 falls & trolley 2 falls	276787
1000 kg 2 falls & trolley 2 falls	276797

Tralift TT

Range of electric chain hoists - 250 to 6 300 kg.

Designed for permanent installation on a jib crane, underneath an overhead crane, or on motorised or non-motorised trolleys.

- Suitable for the toughest applications and conditions
- Recommended for dusty and humid environments and also for outdoor use
- Extra long service life thanks to the permanently lubricated gearbox and the profiled steel
- chain with manganese phosphate coating
- Application range: -15 to +50°C
- Low weight and overhead height due to the compact housing
- Reinforced load hook with forged safety catch
- Alternating current (230V / 1Ph / 50Hz) or three-phase current (400V / 3Ph / 50Hz)
- Ergonomic remote control, wired or wireless
- Corrosion resistant finish

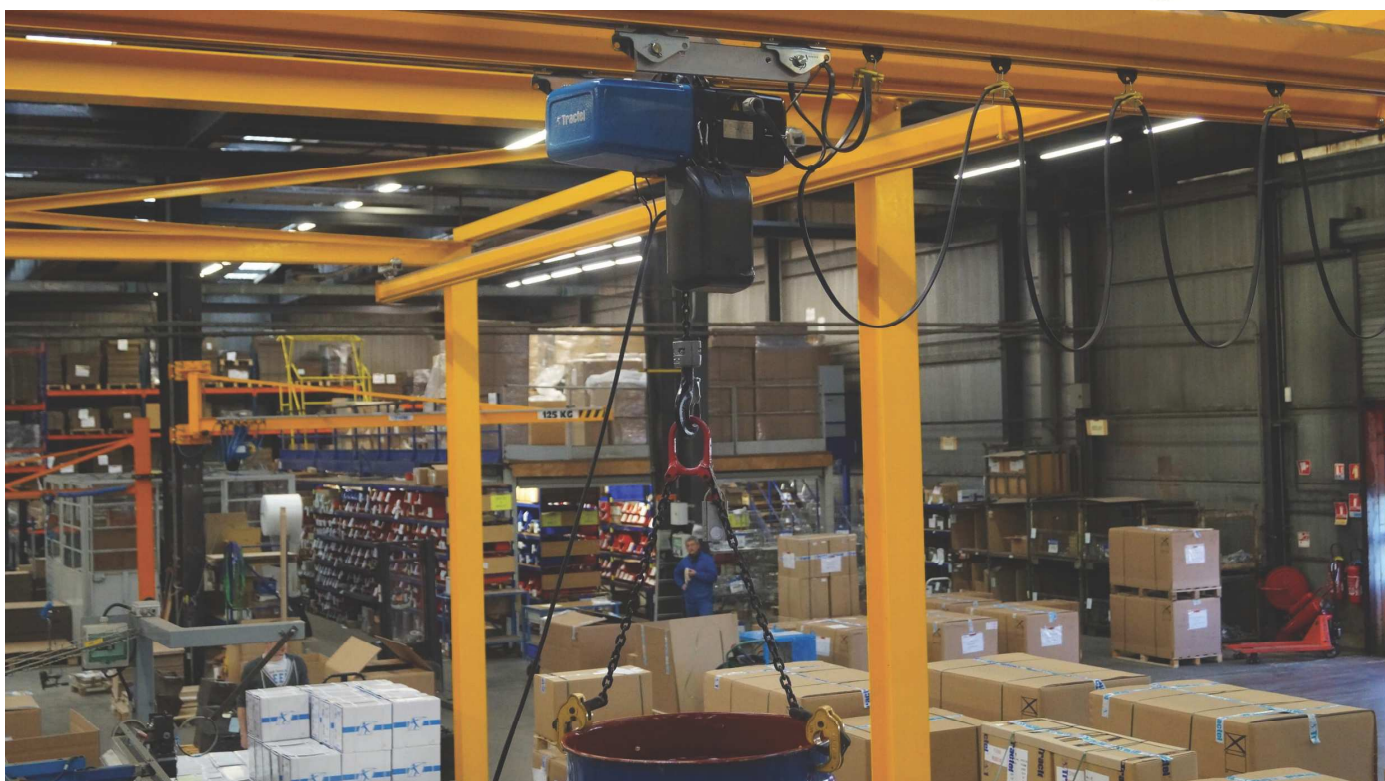

Tralift TT

Range of electric chain hoists from 250 to 6 300 kg.

Customize your Tralift TT starting from the starter kit.

Add the desired options to get the Tralift TT hoist that matches your project.



Hook included

Starter pack : Lifting height 3 m / Pendant control box 1,80 m					Options			
WLL (kg)	Nb of falls	Nb of speeds	Lifting speed (m/min)	Code	Additional lifting height		Pendant control box : additional meter	
					Additional meter	Maximum Length	Additional meter	Maximum Length
250	1	2	8/2	278139	232507	240 m	195127	239 m
500	2	2	4/1	278179	232517	120 m	195127	119 m
500	1	2	8/2	278159	232527	120 m	195127	119 m
1,000	2	2	4/1	278219	232647	60 m	195127	59 m
1,000	1	2	8/2	278199	232637	55 m	195127	54 m
1,600	2	2	4/1	278239	239547	25 m	195127	24 m
1,600	1	2	8/2	293049	281137	35 m	195127	34 m
2,000	2	2	4/1	278259	239547	15 m	195127	14 m
2,000	1	2	8/2	293719	281157	15 m	195127	14 m
2,500	1	2	8/2	293089	281157	7 m	195127	6 m
3,200	2	2	4/1	293069	281147	28 m	195127	27 m
3,200	1	2	6,4/1,6	293099	281157	28 m	195127	27 m
5,000	2	2	4/1	293129	281167	14 m	195127	13 m
6,300	2	2	3,2/0,8	293139	281167	14 m	195127	13 m

Tralift TT

Range of electric chain hoists from 250 to 6 300 kg.

Options

Model	Product Code
Thermal protection for tralift™ TT	211587
Option radio remote control for tralift™ TT 2501B 5002B 5001B 1T2B 2V	278357
Option radio remote control for tralift™ TT 1T1B 2T2B 2V	278367
Option radio remote control for tralift™ TT 16001B 32002B 2V	281337
Option radio remote control for tralift™ TT 25001B 63002B 2V	281377
TTP 1250 - low height manual trolley for Tralift TT 250 / 500 (crosspiece included 70-140mm)	278957
Wide crossbeam option - Iron width 70 - 240 mm for electric trolley	282107
TTP 2500 - low height manual trolley for Tralift TT 1000 / 1600 (crosspiece included 88-200mm)	278967
TTP 6300 - low height manual trolley for Tralift TT 2000 / 2500 / 3200 / 5000 / 6300 (crosspiece included 91-300mm)	278987
Wide crossbeam option - Iron width 88-300 mm for electric trolley	282117

Chain bags

WLL (kg)	Nb of falls	1	2	3	4	5	6	7	8	9	10	12	14	16	17	20	27	28	30	35	40	55	60	120	240
250	1																								
500	2																								
500	1																								
1000	2																								
1000	1																								
1600	2																								
1600	1																								
2000	2																								
2000	1																								
2500	1																								
3200	2																								
3200	1																								
5000	2																								
6300	2																								

Tralift TT

Range of electric chain hoists from 250 to 6 300 kg - Electric trolley 2 speeds 12 - 4 m/min.

Customize your Tralift TT starting from the starter kit.

Add the desired options to get the Tralift TT hoist that matches your project.



Starter pack : Lifting height 3 m / Pendant control box 1,80 m					Options				
WLL (kg)	Nb of falls	Nb of speeds	Vitesse de levée (m/min)	Code	Additional lifting height		Pendant control box : additional meter		Traverse for electric trolley
					Additional meter	Maximum Length	Additional meter	Maximum Length	Standard (mm)
250	1	2	8/2	278279	232507	120 m	239597	119 m	70-140
500	2	2	4/1	278319	232517	60 m	239597	59 m	70-140
500	1	2	8/2	278299	232527	120 m	239597	119 m	70-140
1,000	2	2	4/1	278359	232647	60 m	239597	59 m	88-200
1,000	1	2	8/2	278339	232637	120 m	239597	119 m	88-200
1,600	2	2	4/1	278379	239547	60 m	239597	59 m	88-200
2,000	2	2	4/1	278399	239547	120 m	239597	119 m	91-300
1,600	1	2	8/2	293199	281137	35 m	239597	119m	91-300
2,000	1	2	8/2	293729	281157	32 m	239597	31 m	91-300
2,500	1	2	8/2	293239	281157	32 m	239597	31 m	91-300
3,200	1	2	6,4/1,6	293249	281157	32 m	239597	31 m	91-300
5,000	2	2	4/1	294019	281167	16 m	239597	15 m	91-300
6,300	2	2	3,2/0,8	294029	281167	16 m	239597	15 m	91-300

Model	Product Code
Wide crossbeam option - Iron width 70 - 240 mm for electric trolley	282107
Wide crossbeam option - Iron width 88-300 mm for electric trolley	282117

Tralift TT

Range of electric chain hoists from 250 to 6 300 kg - Electric trolley 2 speeds 12 - 4 m/min.

Options	Code produit
End limit switch for e-trolley	282347
Thermal protection for tralift™ TT	211587
IP 65 for trolley	211607
Option radio remote control for tralift™ TT 16001B 32002B 2V CH2V	281357
Option radio remote control for tralift™ TT 25001B 63002B 2V CH2V	281397
Option radio remote control for tralift™ TT 2501B 5002B 5001B 1T2B 2V C2V	278397
Option radio remote control for tralift™ TT 1T1B 2T2B 2V CH2V	278407

Chain bags

WLL (kg)	Nb of falls	1	2	3	4	5	6	7	8	9	10	12	14	16	27	28	30	35	40	55	60	120	240
250	1														231987						233027		233057
500	2														231987						233027		233057
500	1														231987						233027		233057
1000	2														231987						233027		233057
1000	1														232797						278687		
1600	1														281177						281197		
1600	2														232797						278687		
2000	2														232797						278687		
2000	1														281177						281197		
2500	1														281177						281197		
3200	1														281177						281197		
5000	2														281177						281197		
6300	2														281177						281197		

Tralift TT one phase

Range of one phase electric chain hoists - 125 to 2 000 kg.

Customize your Tralift TT hoist starting from the starter kit.

Add the desired options to get the Tralift TT hoist that matches your project.

Starter pack : Lifting height 3 m / Pendant control box 1,80 m					Options			
WLL (kg)	Nb of falls	Nb of speeds	Lifting speed (m/min)	Code	Additional meter	Maximum Length	Pendant control box : additional meter	Maximum Length
125	1	1	8	294179	232507	15 m	195127	14 m
250	1	1	8	278969	232507	15 m	195127	14 m
500	2	1	4	278989	232517	7 m	195127	6 m
500	1	1	8	294079	232527	15 m	195127	14 m
1,000	2	1	2	279009	232647	7 m	195127	6 m
1,000	1	1	4	293159	232637	15 m	195127	14 m
2,000	2	1	2	293179	239547	7 m	195127	6 m

Model	Product Code
Option radio remote control for tralift™TT 250 1B 500 2B-1B 1T 2B 1V	278337
Option radio remote control for tralift™ TT 1T1B 2T2B 1V	278347
TTP 1250 - low height manual trolley for Tralift TT 250 / 500 (crosspiece included 70-140mm)	278957
Wide crossbeam option - Iron width 70 - 240 mm for electric trolley	282107
TTP 2500 - low height manual trolley for Tralift TT 1000 / 1600 (crosspiece included 88-200mm)	278967
Wide crossbeam option - Iron width 88-300 mm for electric trolley	282117
TTP 6300 - low height manual trolley for Tralift TT 2000 / 2500 / 3200 / 5000 / 6300 (crosspiece included 91-300mm)	278987

Chain bags

WLL (kg)	Nb of falls	1	2	3	4	5	6	7	8	9	10	20	30	40	50
125	1											282727			
250	1											231987			
500	2											231987			
500	1											231987			
1000	2											231987			
1000	1											232797			
2000	2											232797			

Tralift TT one phase

Range of one phase electric chain hoists - 250 to 2 000 kg - with electric trolley 1 speed (12 m/min).

Customize your Tralift TT hoist starting from the starter kit.

Add the desired options to get the Tralift TT hoist that matches your project.

Starter pack : Lifting height 3 m / Pendant control box 1,80 m -					Options				
WLL (kg)	Nb of falls	Nb of speeds	Lifting speed (m/min)	Code	Additional lifting height		Pendant control box : additional meter		Crosses for electric trolley Standard (mm)
					Additional meter	Maximum Length	Additional meter	Maximum Length	
250	1	1	8	279029	232507	15 m	239597	14 m	70 - 140
500	1	1	4	279049	232517	7 m	239597	6 m	70 - 140
500	2	1	4	294089	232527	15 m	239597	14 m	70 - 140
1,000	2	1	2	279069	232647	7 m	239597	6 m	88 - 200
1,000	1	1	4	294049	232637	15 m	239597	14 m	88 - 200
2,000	2	1	2	294069	239547	7 m	239597	6 m	88 - 200

Options	Code
Wide crossbeam option - Iron width 70 - 240 mm for electric trolley	282107
Wide crossbeam option - Iron width 88-300 mm for electric trolley	282117
Option radio remote control for tralift™ TT 2501B 5002B 5001B 1T2B 1V C1V	278417
Option radio remote control for tralift™ TT 1T1B 2T2B 1V CH1V	278427

Chain bags

WLL (kg)	Nb of falls	1	2	3	4	5	6	7	8	9	10	20	30	40	50
250	1											231987			
500	2											231987			
500	1											231987			
1000	2											231987			
1000	1											232797			
2000	2											232797			

Tralift TTR

Range of electric chain hoists equipped with STAINLESS STEEL load lifting chain - 250 to 1 000 kg.

Customize your Tralift TTR hoist starting from the starter kit.

Add the desired options to get the Tralift TTR hoist that matches your project.

Starter pack : Lifting height 3 m / Pendant control box 1,80 m					Options			
WLL (kg)	Nb of falls	Nb of speeds	Lifting speed (m/min)	Code	Additional lifting height		Pendant control box : additional meter	
					Additional meter	Maximum Length	Additional meter	Maximum Length
250 kg	1	2	8 - 2 m/min	279429	238737	120 m	195127	119 m
500 kg	1	2	8 - 2 m/min	293739	276957	120 m	195127	119 m
500 kg	2	2	4 - 1 m/min	279439	270117	120 m	195127	119 m
1,000 kg	2	2	4 - 1 m/min	279449	238747	60 m	195127	59 m
250 kg	1	1	8 m/min	279459	238737	120 m	195127	119 m
500 kg	2	1	4 m/min	279469	270117	120 m	195127	119 m

Model	Product Code
Option radio remote control for tralift™ TT 2501B 5002B 5001B 1T2B 2V	278357
Option radio remote control for tralift™TT 250 1B 500 2B-1B 1T 2B 1V	278337

Chain bags

WLL (kg)	Nb of falls	1	2	3	4	5	6	7	8	9	10	12	14	16	20	28	30	40	60	120	240
250	1																				
500	1																				
500	2																				
1000	2																				
250	1																				
500	2																				

Tralift TT - special models



Tralift TT ATEX

To be used in EX proof site (ATEX).



Tralift TTHK

Handy chain model for fast and easy handling of loads

- Control of electric chain hoist and guidance of the load with one hand
- Control unit with rocker switch for left- and right-handed operation
- Hook end positions adjustable by geared limit switch
- Can be combined with slewing or suspended cranes

Option: handy kit for retrofitting of standard electric chain hoist

Option: with frequency inverter



Tralift TTS

Synchronized electric chain hoists for handling of large and bulky loads:

- Precise parallel run of two hooks without twisting the load
- With temperature monitoring
- Hook position individually adjustable by geared limit switch
- Distance between load hooks 0.7-5.0 m
- Perfect to combine with suspended crane or travelling crane

Option: with trolleys

Option: with frequency inverter



Tralift TTW

Electric chain hoist for wind turbines:

- Lifting speed up to 16 m/min
- Lifting height up to 200 m
- Temperature monitoring with shutdown function of the motor in case of overheating
- Automatic switching from high to low lifting speed shortly before the stroke end by geared limit switch
- External limit switches for hook end positions
- Tempered special chain
- Load hook with protective cover

Option: with manual or motorised trolley

Option: chain container

Power Line Systems

Flat cable conductor systems

- Galvanized track rail length 2 m, with connectors
- Rail brackets to be clamped
- Cable trolleys, tow trolley
- Cable-fixed end stops
- Terminal box
- Flat cable with cable glands

Model	Product Code
4 m	38018
5 m	38028
6 m	38038
7 m	38048
8 m	38058
9 m	38068
10 m	38078
11 m	38088
12 m	38098
13 m	38108
14 m	38118
15 m	38128
16 m	38138
17 m	38148
18 m	38158
19 m	38168
20 m	38178

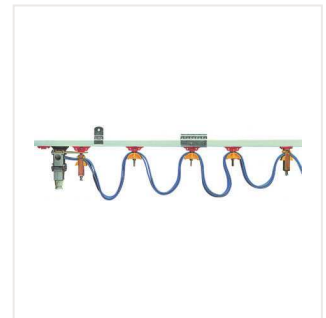

Bus bar conductor system

- PVC section element
- Terminal box
- Covering flange
- Collector trolley with leading arm
- End cap
- Fixing brackets



Tralift TR

Pneumatic chain hoist

- Adjustable lifting speed
- End limit switch
- Compact
- Low headroom
- Disc brake
- Operated pressure: 6,3 bars
- Noise level less than 83 dBA to 1 m

Standard:

- 3 m lift - 2 m control cable
 - Control by pendant rope or pendant box with button and emergency
 - Galvanised lifting chain according to DIN 818-7
 - Overload integrated device 1 fall
 - Complete range up to W.L.L. 75 t
 - Chain box
 - To be used un EX proof site (ATEX). For other zones : confirm classification
-
- Pneumatic traversing trolley : on request



[Consult us](#)

GENERAL CONDITIONS OF SALE AND SERVICE

GENERAL CONDITIONS OF SALE AND SERVICE v. 02.2020

1 – DRAWING UP OF THE AGREEMENT

Any order implies from the buyer, the acknowledgement by the buyer that he gets all required information to the conclusion of the agreement and the acceptance of the present terms. Therefore, no clause to the contrary may be set up against the seller if he has not formally accepted it in writing and notably all the general terms sent earlier by way of circular letters.

Unless otherwise specified, seller's quotation shall expire thirty (30) days from its date.

The sale agreement is perfect only after written acceptance by the seller of the buyer's order, or if not by the delivery.

An order which is accepted cannot be cancelled without the seller's prior and express consent.

2 – SPECIFICATIONS CONCERNING THE SUPPLY

The specifications mentioned in the seller's catalogues, price lists, leaflets and all advertising documents are for information purposes only. The seller reserves the right to carry out all changes he may consider appropriate on his models, even after acceptance of the orders, without, however, the essential specifications and performance being affected.

3 - PRICES Prices are understood in Euros free of any discount, taxes, or insurance for non packaged goods, ex-works (EXW Incoterms® ICC in force at the date when the contract is made).

Any possible costs for packaging, loading and conveying from the factory to the place of delivery shall be born by the buyer, unless otherwise agreed in writing.

4 - PAYMENTS Save exception specified in the special terms appearing on the front page, the price is payable at the seller's head office as follows:

- * part with the order (down payment)

- * the balance by accepted draft 30 days from the date of invoicing.

The payment of the down payment with the order does not in any way entitle the buyer to retract in return for giving up his down payment which, in the event of cancellation of the order, remains acquired to the seller as a compensation, subject to all other rights.

5 - SETTLEMENT

5.1 – The non-payment entails the event of default and causes that all debts even not outstanding ones are immediately due.

5.2 – Penalties for delay and compensation for recovery costs

In the event the special terms specify a deferred payment and that one of the due dates is not observed, the buyer by right and without a prior formal demand, shall lay open to penalties for delay which will be the result of the application of a rate equal to three times the rate of French legal interest.

In addition to penalties for delay, and due to late payment, the buyer, de jure and without prior formal demand, shall pay recovery costs equal to 40 euros. The seller will be entitled to obtain compensation from the buyer for any recovery costs exceeding that fixed sum and incurred due to the buyer's late payment.

5.3 - Penalty clause

By express agreement, the non payment on the due date shall entail, as a penalty clause, a compensation of 15% of the amounts due, plus the interest set in the agreement and any possible costs of litigation.

5.4 – Retention of title and risk of loss

The products, subject-matter of the present order, shall remain by formal agreement the seller's property until full payment of the agreed price, and all means of payment: cheques, drafts or other negotiable instruments shall be considered as payment only after the actual collection of their amount by the seller.

During the period between the delivery and the full payment of the price, the buyer, by formal agreement, shall only be considered as the simple depository of the products, the buyer shall have to pay the price on agreed due dates, or failing payment of a single payment, to pay the full price or, to return the products, or if not he shall incur the penalties provided for by the law.

As an exception to article 1196 of the French Code of Civil Law, the delivery itself shall place the products at the buyer's risks despite the fact the latter is only the depository until full payment is made.

On account of his capacity of simple depository until the full payment of the price, the buyer to whom the products are delivered will not be entitled to resell them or to alienate them by any mean, including by way of contract of pledge, security or otherwise.

However, he may:

- Either, after prior agreement of the seller and under its entire liability, have its buyer pay directly the product subject-matter of the present agreement to the seller.

- Or assign the benefit and the charges resulting from the present agreement, but on the formal condition of informing its assignee under its own liability that the products are subject to a reservation of title clause and that himself is only the depository until full payment of their price, in such a manner that said assignee has himself only the capacity of depository until the payment, and that the seller may be able to claim from him the payment or the return, if the amount of the price is not paid in whole on the date due.

GENERAL CONDITIONS OF SALE AND SERVICE

TRACTEL SAS GENERAL CONDITIONS OF SALE AND SERVICE v. 02.2020

6 – DELIVERY TIME & DELIVERY

6.1 – Delivery means the placing at disposal of the product on the site notified by the seller.

6.2 – The delivery time is the date entered by the seller on its acknowledgment of receipt of the order.

6.3 – Delivery times are given for information purposes and without commitment. The seller commits to deliver promptly the goods to the buyer provided that the seller gets all the information and documents required for the performance of the contract.

6.4 – It is expressly agreed that the seller shall owe no compensation for delay, except in the event of deliberate tortious intent.

6.5 - a) The buyer shall take delivery of its product(s) in the seller's premises within 30 days following the notification of the seller that the product(s) are ready for delivery.

b) At the end of this 30-day period, and after a formal demand by registered letter with advice of delivery sent to the buyer to remove the product(s) IMMEDIATELY, the seller shall be entitled to force the buyer to perform its obligations, notably to make the payments, the delivery being considered as made; in this case the seller shall store the products at the buyer's risks.

c) After the time-limit provided for in article b), the seller shall be able, if it deems this appropriate, to consider the agreement as terminated by the buyer, the payments received from the latter being acquired to him without prejudice of any other rights, and notably the seller shall be entitled to demand as a penalty clause the payment of a compensation equal to 15% of the sale price of the equipment. The seller shall then, after advising the buyer by registered letter, use the products as it wishes.

d) The products are delivered with their instructions manual for use; the user shall read them before using the products. The buyer shall check and see if he has the documents, if not it shall contact the seller to get them.

e) Acceptance: Without any written claims within 30 days following the date of delivery, the product shall be considered as without any visible defects and accepted.

7 – TRANSPORT AND INSURANCE

The steps the seller may be led to take in the interest and on behalf of the buyer as regards insurance, transport, do not prevail against the principle of the delivery in the factory or store of the seller.

The fact of possibly including the transport cost in the price does not constitute an exemption to the principle of the delivery made in the factory or the store of the seller. Any transport made by the seller itself, whether the costs are to be paid for by the buyer or not, is considered as made according to a contract of carriage separate from the sale agreement.

If there are no instructions, the seller dispatches the goods in the best interests of the buyer.

In all cases, it is up to the buyer to check everything, to make all reservations upon the arrival of the product and to lodge, if the need arises, against the carrier the appeals, which must be lodged within 3 days following the acceptance, provided for by articles L133-1 and L133-3 of the French commercial Code; should these formalities not be complied with, the carrier's liability may not be implemented and the seller cannot in any case be sued for this reason.

8 - WARRANTY

Term and extent of the Warranty

8.1 – All products are covered against defects in material and construction faults for a period of twelve (12) months from the date appearing on the delivery slip.

8.2 – (i) This warranty is strictly limited, after examination of the product by the seller and to suit its convenience, to the repair or replacement of the product recognized as defective, with the express exclusion of all accessory costs. (ii) Are only covered by the warranty the cost of replaced parts and labour used. Travel costs and hotel expenses for the personnel on the user's site as well as transport costs of the product concerned at the seller's factory and return are to be paid for by the beneficiary of the warranty.

8.3 – The warranty does not cover the damage resulting from bad assembly, insufficient maintenance, or normal wear. It does not apply to paints and coatings.

8.4 – Any defect bringing into play the seller's warranty must, failing forfeiture, be declared to the seller, with the invoice corresponding to the purchase of the product in question and all supporting documents.

8.5 – Exchanges or repairing of parts covered by the warranty cannot extend the warranty.

8.6 – The warranty will be removed from any product which is modified, altered, repaired outside the seller's workshops without the seller's prior written approval.

8.7- The seller's liability is expressly limited to the above-mentioned warranty.

8.8 – An action to enforce the warranty cannot justify any delay in payments.

9 – LIABILITY

Under no circumstances, shall the seller be held to indemnify the consequential direct or indirect damage or contingent damage, notably any operating losses, loss of profits or loss of earnings. The liability of the seller, all causes taken into account with the exception of bodily injuries and gross negligence, is limited to a sum with an upper limit fixed at the amount invoiced and collected of the supply alleged defective.

The buyer is responsible for the waiver in contract against the seller or its insurers beyond the limits and exclusions fixed above.

GENERAL CONDITIONS OF SALE AND SERVICE

TRACTEL SAS GENERAL CONDITIONS OF SALE AND SERVICE v. 02.2020

10 – SERVICE PERFORMANCE

The scale of service performance of the seller is understood exclusive of travel and hotel costs. The estimates for repairs of the seller not followed by an order are payable and include the operations of dismantling, reassembly and trips. Without a reply from the buyer within 30 days from the date appearing on the estimate, the equipment shall be returned as such, transport costs to be paid for by the buyer.

The customer agrees to place at the disposal of the seller a place required for the operation as well as the required means of lifting, handling and trial.

The seller reserves the right to take into account the weather conditions on the site and accept no responsibility for any possible delays due to these conditions or to the non conformity of the site with the public health and safety conditions. Under no circumstance will the seller's liability be sought for the consequences of equipment which stops operating while it intervenes.

The customer must make sure of the solidity of supports, anchoring or props of the equipment set up; it has the responsibility of checking the solidity and the conformity with safety rules.

11 –FORCE MAJEURE

The Parties shall not be held responsible for any delay or failure to execute one of its obligations within the scope of the contract should the delay or failure be the direct or indirect result of a case of force majeure, which is defined as an event beyond the control of the Parties and independent from their will, including but not limited to cyber-attack, civil conflict, revolution, war, acts of God, occurrence of a natural catastrophe and extraordinary weather.

Should the event of Force Majeure last for more than 1 (one) month since its date of notice, then the party suffering from Force Majeure shall be entitled to terminate immediately the present Contract without prejudice by registered letter.

12 - HARDSHIP CLAUSE

The Parties are aware of the fact that this contract is fair and equitable. By mutual agreement, the Parties waive the article 1195 of the French Civil Code and accept to deal with risks associated with changing circumstances.

13 – PERSONAL DATA PROTECTION

The seller processes personal data (full name, address, email, phone number,...) of its buyer's contacts.

The purpose of personal data processing is to perform orders and manage the relationship between the seller and the buyer. These personal data may be shared with companies located within the EU: the other TRACTEL companies, Credit-Insurance companies, Business Element and Microsoft.

No transfer of personal data to third countries (outside European Union) or international organisations is intended.

The buyer undertakes to inform the seller of any update regarding the personal data of the data subject and to inform them of the content of this clause. The data subject benefits from the right to require access to, rectification, erasure of their personal data or restriction to processing of their personal data or to object to processing as well as the right to data portability by writing to rgpd.tsas@tractel.com

The data subject also has the right to lodge a complaint with the CNIL.

The seller undertakes to take appropriate technical measures in order to ensure security and confidentiality of personal data. The seller undertakes to keep personal data no longer than necessary for the purposes of this personal data processing and in any case for a maximum period of 3 years from the last products order to the seller.

14 – PUBLICITY

The seller and/or any other TRACTEL company will be authorised to issue marketing material, publicity, promotion or advertising in whatever form, regarding the goods and services object of the Order; this authorization may be suspended further to the buyer's request.

15 – JURISDICTION

By formal agreement, any disputes or difficulties relating to the construction or to the performance of the present order shall be under the JURISDICTION of the COMMERCIAL COURT of TROYES (10 – France). The present terms are governed by French law excluding the United Nations Convention on Contracts for the International Sale of Goods (Vienne, 1980).

A large, empty rectangular area with a light gray background, intended for a drawing or image. It occupies the central portion of the page, below the title and above the footer.





Safety harness
HT Access



Removable
X-Pad



Fall arrest device
Blocfor 20 Evo

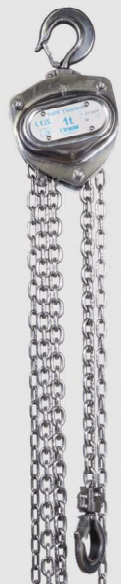

Manual chain hoists
Tralift Cleantech



Stainless steel trolley
Corso Cleantech



Battery powered permanent magnet
Magfor auto



Blocks
EP

GLOBAL REACH



FRANCE **Tractel S.A.S.**

RD 619 Saint-Hilaire-sous-Romilly
BP 38 Romilly-sur-Seine
10102, France
Phone: +33 3 25 21 07 00
Email: info.tsas@tractel.com

www.tractel.com

